

Trade Mark:
CRYSTAL WORLD INC

Product Name: Wall lamp
Model :5062W5C
120Vac, 60Hz, AC ONLY
Lamp Size: W5"xH11"xE8"

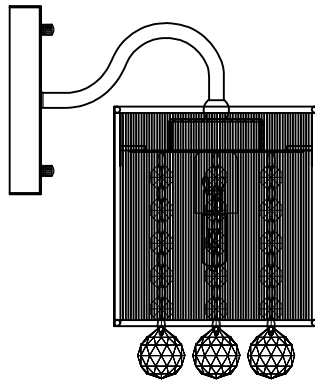

Intertek
4006677

WALL LAMP ASSEMBLY INSTRUCTIONS

1. Place fixture (A) onto Butterfly (EE).
Secure with cap nuts (AA). Please
put (B) onto (A).

Hardware Used

AA Cap nut  X 2

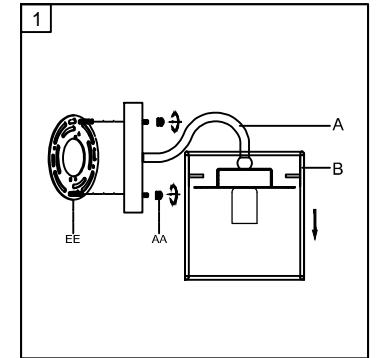

2. Please hang the crystal (1) to the
fixture (A).

1
14mm*5PCS
30mm*1PCS
5PCS

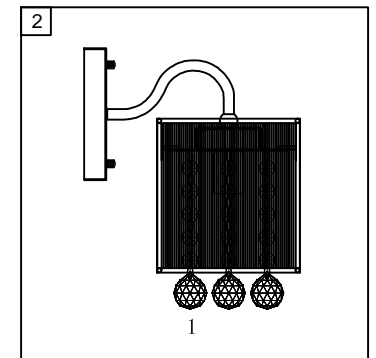

3. Install light bulbs (not included).
Use bulb

120V G9  1x40W Max.

