

REMOTE CONTROLLER INSTALLATION INSTRUCTION

IMPORTANT NOTE:

- 1.) You must set ceiling fan manual switch to high speed and light kit (if any) to on position before operating remote control.
- 2.) Read and save these instructions.
- 3.) Please note that all-fixed wiring appliances should be installed by a qualified electrician.
- 4.) The supply to the remote control receiver should be connected through a mains switch, i.e. existing wall switch.
- 5.) Before installing Remote Controller, make sure the Main Power Supply is turned off.
- 6.) Install receiver into the ceiling fan canopy of the fan to ensure proper protection.
- 7.) Electric Rating: AC120V, Light: 300W (Max), Fan: 1.25A (Max).
- 8.) Do not install in damp locations or immerse into water. (For indoor use only.)
- 9.) Do not install in Tungsten Light kit, only for the Energy saving bulb.
- 10.) Do not pull on or cut leads shorter.
- 11.) Do not drop or bump the unit.
- 12.) The Battery will weaken with age and should be replaced before leaking takes place as this will damage the transmitter. Dispose of used battery properly. Keep the battery out of reach of children.
- 13.) CAUTION: To reduce the risk of fire or injury, do not use this product in conjunction with any variable(rheostat) wall control.

SET CODE SWITCH BETWEEN TRANSMITTER AND RECEIVER:

There is a code switch in transmitter and receiver (See Fig.1). First. Set all of the 4 keys at "ON" position. If more than one remote controlled fan is installed or the code interfered, the fan may function abnormally. In this situation, you need to reset the fan code switch as per following instructions. Please use a ball pen (or any convenient tool) to poke keys to select a desired code mode which will not interfere with other electrical units. There are 15 code modes for selection excluding the original ex-factory mode. (See Fig.2)

*** Please note to change the code switches in the transmitter & receiver at the same time & at the same key position.***

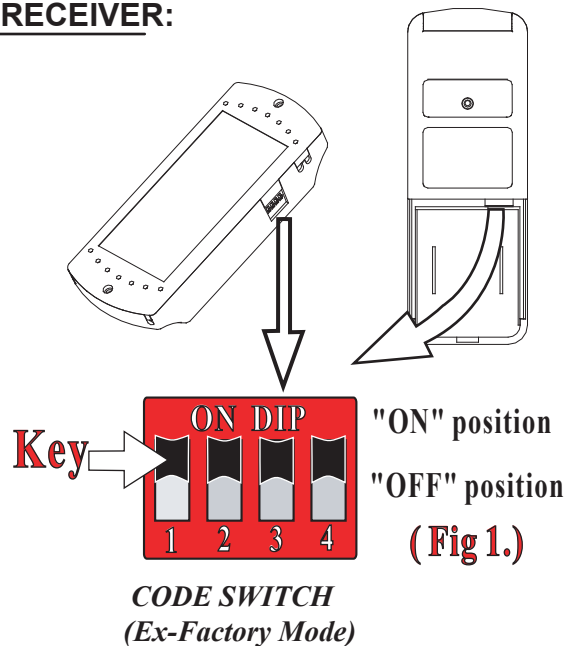

- When 1 key is in "OFF" position. ----->
 - When 2 keys are in "OFF" position. ----->
 - When 3 keys are in "OFF" position. ----->
 - When 4 keys are in "ON" or "OFF" position. ----->
- (Fig 2.)

INSTALL AND MAKE WIRE CONNECTION:

- 1.) Make sure the electric power was turned off.
- 2.) Ceiling fan must be set at HIGH speed and light kit (if any) at ON position by pulling the "Pull Switch" after installation.
- 3.) Once the connection has been made, the receiver inserts into the drop rod hanging bracket. The canopy comes up to cover the receiver and bracket. (See Fig.3)
- 4.) Make Wire Connection: (See Fig.4)

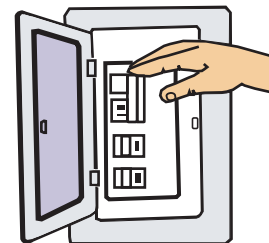

- a. The Motor **white** wire to the **white "To Motor N"** wire from Receiver with a wire nut.
- b. The Motor **black** wire to the **black "To Motor L"** wire from Receiver with a wire nut.
- c. The Motor **blue** wire to the **blue "For Light"** wire from Receiver with a wire nut.
- d. The **white** wire from Outlet Box to the **red "AC in N"** wire from Receiver with a wire nut.
- e. The **black** wire from Outlet Box to the **red "AC in L"** wire from Receiver with a wire nut.

Make sure all of wire nuts are connected firmly.

Tuck all wire nuts and wires carefully up into the Outlet Box, EXCEPT antenna, which should remain outside Outlet Box.

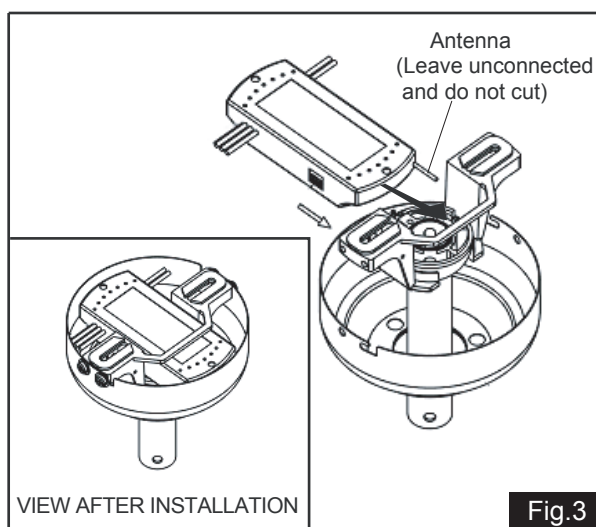

Fig.3

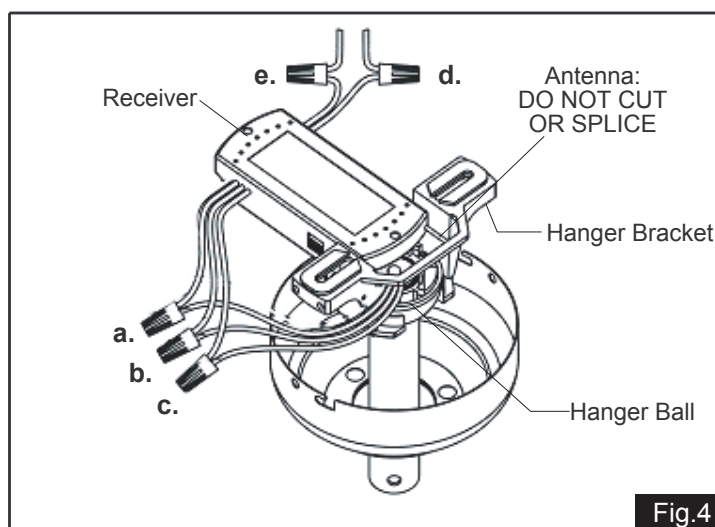

Fig.4

- 5.) Install a 9V battery (not included) into the transmitter. Turn on the power, press button of transmitter to operate the fan. (See Fig.5)
- 6.) Functions of Transmitter. (See Fig.6)

- HI:** Turn on the fan at high speed.
MED: Turn on the fan at medium speed.
LOW: Turn on the fan at low speed.
FAN/OFF: Turn off the fan.
LIGHT ON/OFF:

Press and release immediately to turn on or off the light.

Note:

This remote controller has memory function setting. The fan will operate at the same speed and the fan light will stay at the same status as the last time the power supply was turned off.

- 7.) Install the transmitter wall bracket in wall by two screws and hang transmitter in it carefully. (See Fig.7)

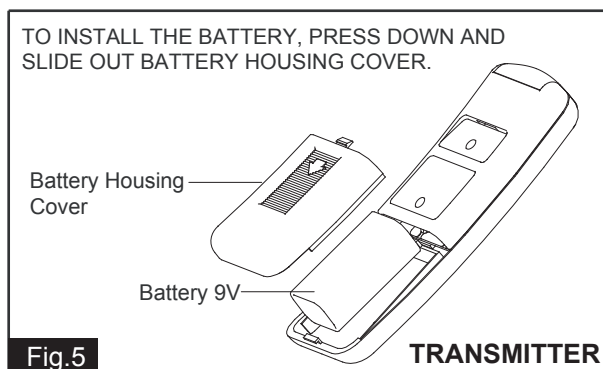

Fig.5

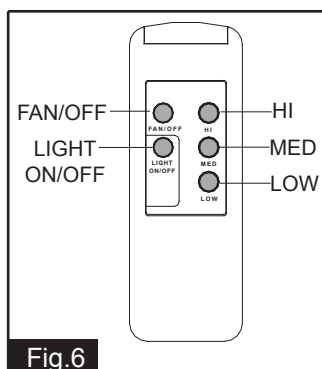

Fig.6

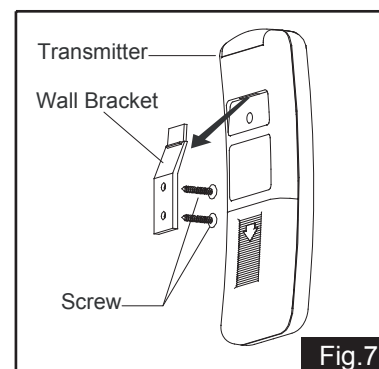

Fig.7